



4/10 Thomas Street Milton NSW

3  2  3 

Find your groove, living in this fantastic townhouse, right in the heart of the most eclectic village on the gorgeous South Coast.

Located at the end of a row of 4 units, this tri level townhouse is private, spacious and light filled. And yet is on the doorstep of all the fabulous restaurants, cafes, bars and boutiques that give Milton its charm.

You will enjoy the gorgeous views over rural Milton, to Green Island and beyond from both the lovely living space and also the master bedroom. The well appointed kitchen and dining space flows out to a sunny fenced courtyard. This stylish home has new carpet, new light fixtures and ceiling fans, plus many other fab features, not the least is the huge 2-3 car garage, which is so unusual for a townhouse.

Price : \$ 575,000

View : <https://www.coopercoastalproperties.com.au/sale/nsw/shoalhaven/milton/residential/house/5834731>

4/10 Thomas Street, Milton



SECOND FLOOR



FIRST FLOOR

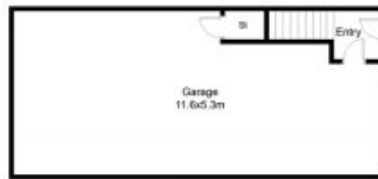

GROUND FLOOR

Approx Home Area: 216m²

DISCLAIMER: ALL MEASUREMENTS ARE APPROXIMATE, NOT TO SCALE. FOR ILLUSTRATION PURPOSES ONLY.

