



13 Acacia Street Fishermans Paradise NSW

3  1  1 

Cute coastal cottage tucked away in the quiet village of Fishermans Paradise, close to the shores of Conjola Creek and Lake Conjola, where you can fish, swim, and kayak or take a quiet stroll along the foreshore.

The 696 m2 block offers tranquility and privacy, set back from the street with a treed outlook and a large level fenced backyard for the kids and pets. The home features a split level floorplan, with front verandah and enclosed back patio.

Only a 10min drive to the historic township of Milton, with its popular cafes, restaurants, boutiques and entertainment.

Homes in the area are being snapped up so don't miss this opportunity to invest or move in and enjoy. Call today to inspect.

Price : \$ 450,000
Building Size : 96 sqm
Land Size : 696 sqm
View : <https://www.coopercoastalproperties.com.au/sale/nsw/shoalhaven/fishermans-paradise/residential/house/6017271>



Craig Cooper
0434 311 113

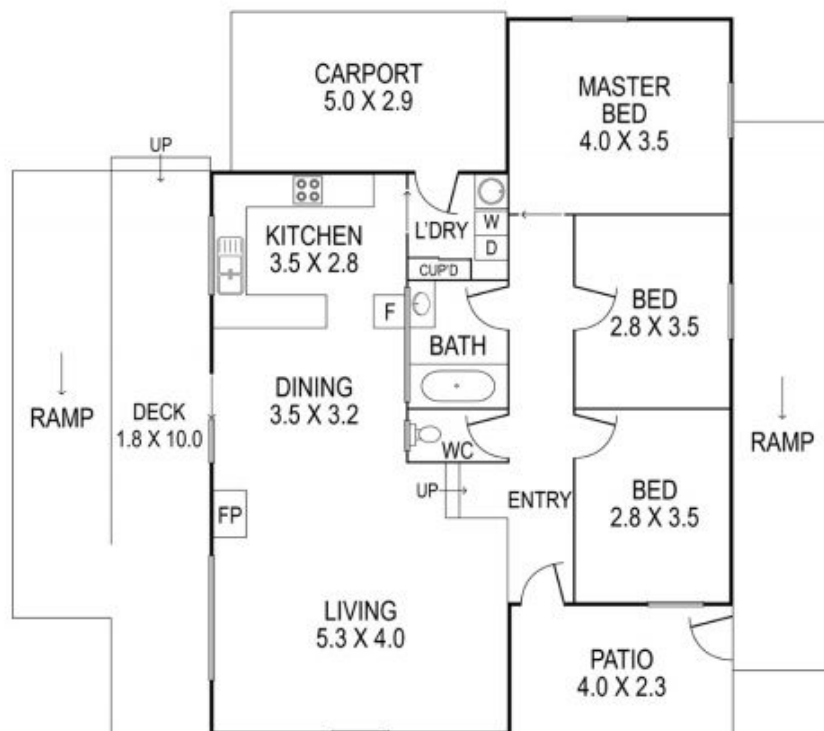

INTERIOR	96 m ²
EXTERIOR	74 m ²
TOTAL	170 m ²

13 Acacia Street, Fishermans Paradise

3 1 1

Disclaimer: The artist impressions and floorplans are indicative only, are not to scale and do not form part of any Contract of Sale. Any dimensions, finishes or specifications depicted are subject to change without notice. Consultants and agents do not warrant the accuracy of any information provided and do not accept any liability for negligence, any error, misrepresentation, discrepancy in the information or reliance thereon.

cooper
COASTAL PROPERTIES