



#### 4 Gadu Street Dolphin Point NSW

4  2  5 

A stunning coastal design set in a seaside location with views to Pigeon House Mountain and the Budawang Ranges. This newly completed home is ready for you to move in and start enjoying the laid back coastal lifestyle of Dolphin Point. Stroll to the nearby beach, lake or National Park. Walk or cycle to your local bakery & cafes to pick up coffee and breakfast, and then immerse yourself in all of the leisure activities on offer in Dolphin Point and Burrill Lake.

The huge north facing living/dining area with vaulted ceilings & highlight windows, is where your friends and family will congregate, adjacent to the central gourmet kitchen and elevated deck. The large butler's pantry, dual ovens and gas hotplate are great additions when you're ready to cook up a storm or step out to the large deck to enjoy a drink, start up the barbecue and enjoy the coastal

**Price** : By Negotiation  
**Building Size** : 221 sqm  
**Land Size** : 600 sqm  
**View** : <https://www.coopercoastalproperties.com.au/sale/nsw/shoalhaven/dolphin-point/residential/house/6632466>



**Craig Cooper**  
0434 311 113

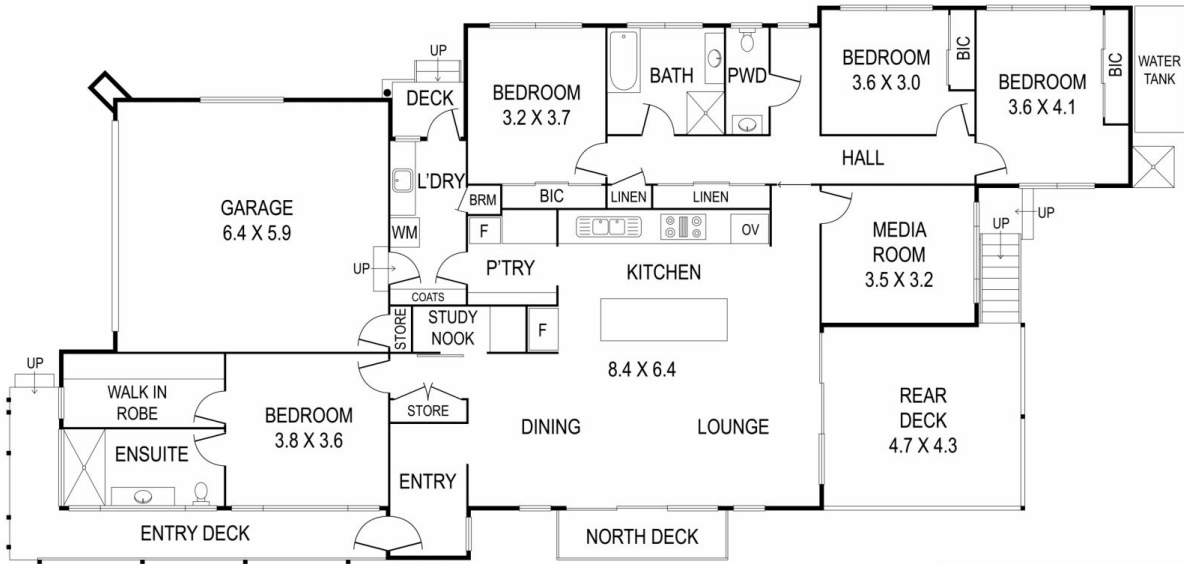

INTERIOR	221 m <sup>2</sup>
EXTERIOR	42 m <sup>2</sup>
TOTAL	263 m <sup>2</sup>

## 4 Gadu Street, Dolphin Point

4 2.5 2

Disclaimer: The artist impressions and floorplans are indicative only, are not to scale and do not form part of any Contract of Sale. Any dimensions, finishes or specifications depicted are subject to change without notice. Consultants and agents do not warrant the accuracy of any information provided and do not accept any liability for negligence, any error, misrepresentation, discrepancy in the information or reliance thereon.

