



14A Kyeema Drive Milton NSW

4  2  6 

Bask in the peace and tranquillity of this country style home set on 5 acres with expansive rural views. Fully fenced, with 2 acres cleared, there is plenty of space for kids and pets to roam and opportunities for organic gardening, chickens or horses.

Exuding country warmth and hospitality with its high ceilings and gorgeous Spotted Gum flooring, the four bedroom home enjoys pastoral views from every window. Sit back and enjoy the ambiance of a wood burning combustion fire which will keep you warm in winter, while the north south aspect, ceiling fans and new ducted air conditioning will keep you cool in summer. The kitchen has all new appliances including 2 drawer dishwasher and a bay window to enjoy the rural views while you cook up a storm to enjoy al fresco on the large north facing terrace.

Building Size : 174 sqm
Land Size : 4.94 Acres
View : <https://www.coopercoastalproperties.com.au/sale/nsw/shoalhaven/milton/residential/acreagesemirural/6817620>



Craig Cooper
0434 311 113

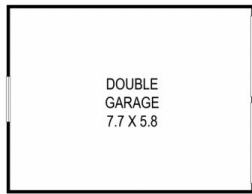
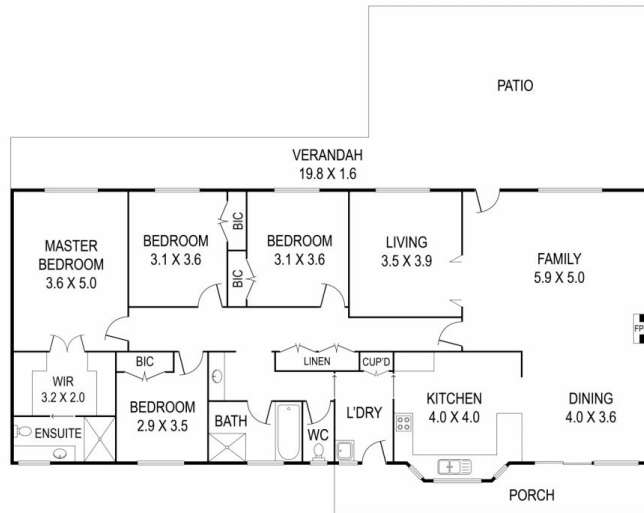

(NOT IN POSITION)



INTERIOR	174 m ²
EXTERIOR	129 m ²
TOTAL	303 m²

14A Kyeema Drive, Woodstock

4 2 2

Disclaimer: The artist impressions and floorplans are indicative only, are not to scale and do not form part of any Contract of Sale. Any dimensions, finishes or specifications depicted are subject to change without notice. Consultants and agents do not warrant the accuracy of any information provided and do not accept any liability for negligence, any error, misrepresentation, discrepancy in the information or reliance thereon.

