

189 Murrays Road Conjola NSW

3  2  4 

This beautiful contemporary style home set on five acres was designed to showcase the beautiful views you will enjoy from nearly every room.

Making a statement with its unique design, the home beautifully accommodates the slope of the land and combines environmental considerations without compromising on comfort. Light and airy interiors, high ceilings, gorgeous recycled Blackbutt flooring and those stunning views create an expansive feel throughout.

Wake up feeling at one with nature as you gaze out over escarpment and valley views. Enjoy an early morning swim at nearby Bendalong beaches, or stunning Lake Conjola. Breakfast on the casual outdoor eating nook or cosy up inside next to the wood fire.

Land Size : 1.82 ha

View : <https://www.coopercoastalproperties.com.au/sale/nsw/shoalhaven/conjola/residential/house/6924273>



Craig Cooper
0434 311 113

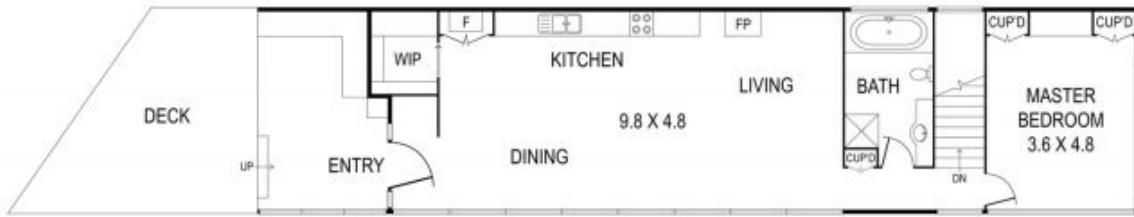

UPPER LEVEL



LOWER LEVEL



INTERIOR	145 m ²
EXTERIOR	79 m ²
TOTAL	224 m²

189 Murrays Road, Conjola

3 2 4

Disclaimer: The artist impressions and floorplans are indicative only, are not to scale and do not form part of any Contract of Sale. Any dimensions, finishes or specifications depicted are subject to change without notice. Consultants and agents do not warrant the accuracy of any information provided and do not accept any liability for negligence, any error, misrepresentation, discrepancy in the information or reliance thereon.

