



173 Princes Highway Burrill Lake NSW

2 1 2

Walking distance to Dolphin Point, Burrill Lake shops and the lake's edge, this 2 bedroom home is a great first home owner or investment property. Offering single level living, a great backyard and transport close by, the home is ideally positioned to enjoy the walking and bike trails plus all the water sports: swimming, surfing, paddle boarding, kayaking, skiing, boating and fishing.

The block is level and fully fenced with established easy maintenance garden plus garden shed, and plenty of room for kids and pets to play.

- * Air conditioning and fans
- * Enclosed sunroom/family room
- * Large under cover area at rear
- * Close to transport
- * 600m to shops & cafes, 700 m to Park, 850 m to Lake

Price : \$ 725,000
Building Size : 119 sqm
Land Size : 557 sqm
View : <https://www.coopercoastalproperties.com.au/sale/nsw/shoalhaven/burrill-lake/residential/house/6946956>



Craig Cooper
0434 311 113

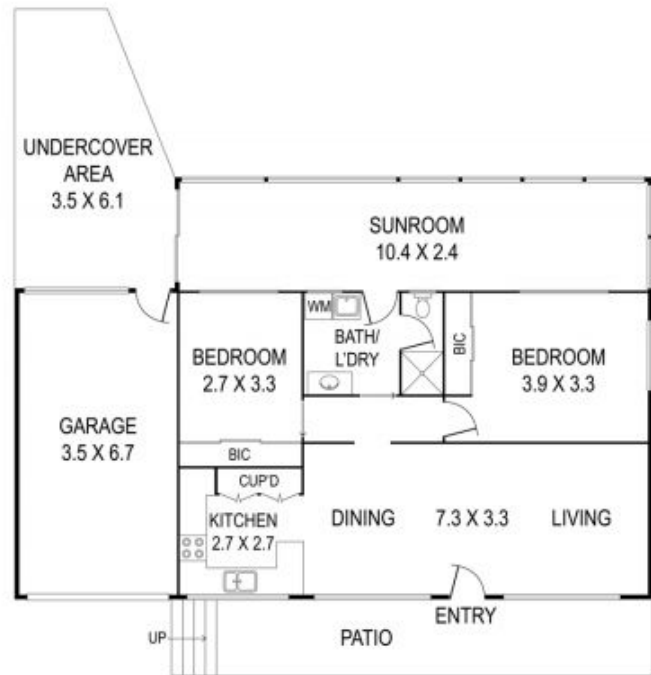

INTERIOR	119 m ²
EXTERIOR	37 m ²
TOTAL	156 m ²

173 Princes Highway, Burrill Lake

2 1 1

Disclaimer: The artist impressions and floorplans are indicative only, are not to scale and do not form part of any Contract of Sale. Any dimensions, finishes or specifications depicted are subject to change without notice. Consultants and agents do not warrant the accuracy of any information provided and do not accept any liability for negligence, any error, misrepresentation, discrepancy in the information or reliance thereon.

