



25 Pitman Avenue Ulladulla NSW

4  3  3 

Wake up to the sound of the waves from this perfectly positioned 2 storey beach house in a quiet street. Take in the ocean views from the master bedroom, before enjoying a relaxing cuppa on the sunny north facing balcony overlooking Heathland Nature Reserve and deciding between an early morning walk or a swim at your choice of nearby beaches - Racecourse, Flat Rock or Rennies.

Cook up a storm and entertain family & friends while looking out on beautiful ocean vistas from the expansive open plan kitchen, dining and living room, or head out to the elevated deck for a barbecue. Enjoy the relaxed coastal lifestyle with timber floors, fans and a slow combustion wood fire to cosy up to in winter.

There is plenty of room for all the family with master and ensuite, another 2 bedrooms, study and bathroom upstairs.

Land Size : 664 sqm
View : <https://www.coopercoastalproperties.com.au/sale/nsw/shoalhaven/ulladulla/residential/house/7274129>



Craig Cooper
0434 311 113

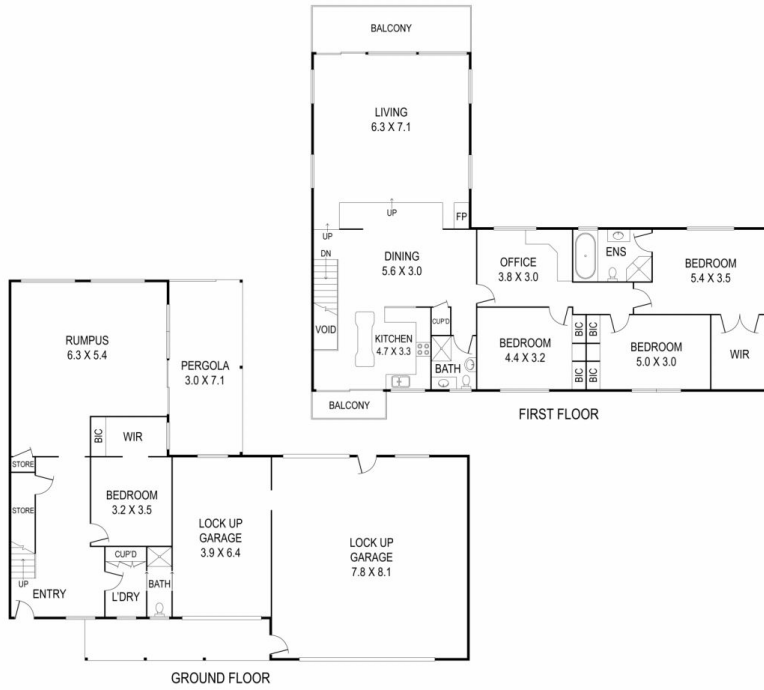

INTERIOR 343 m²

TOTAL 343 m²

4 3 3

25 Pitman Avenue, Ulladulla

Disclaimer: The artist impressions and floorplans are indicative only, are not to scale and do not form part of any Contract of Sale. Any dimensions, finishes or specifications depicted are subject to change without notice. Consultants and agents do not warrant the accuracy of any information provided and do not accept any liability for negligence, any error, misrepresentation, discrepancy in the information or reliance thereon.

