



29 Woodburn Road Morton NSW

4 🏠 1 🚗 5 🚗

Offering an elevated outlook over the green rolling hills of your own farmland and boasting outstanding ocean views, this picturesque equine property and country home is a rare find. Fully fenced and well set up for horse enthusiasts with paddocks, horse arena, animal shelter and feed shed, undercover parking for the horse float and plenty of space to ride through cleared and treed sections of the property.

The single level country style home features wrap around verandahs and raked timber ceilings, north facing highlight windows to capture the light, and a cosy wood fire to keep you warm in winter.. Enjoy the beautiful views from most windows, looking out over rolling green pastures, friendly equine faces and the stunning ocean views. Practical hard wearing slate floors at front and rear entries, kitchen, dining and living rooms and beautiful spotted gum timber floors in

Price : Price on Application
Building Size : 252 sqm
Land Size : 4.38 ha
View : <https://www.coopercoastalproperties.com.au/sale/nsw/shoalhaven/morton/residential/rural/7410383>



Craig Cooper
0434 311 113

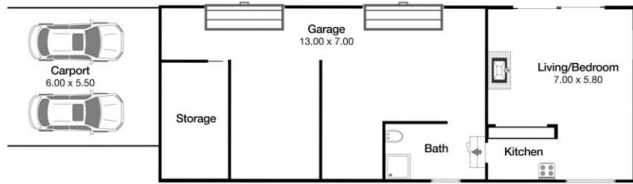

Garage & Studio

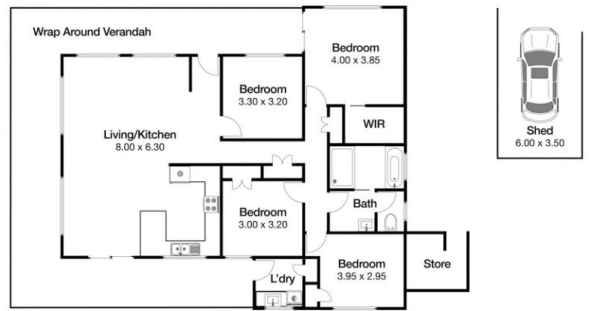

Main Residence



29 Woodburn Rd Morton

INTERIOR 252m²

5 2 5

Disclaimer: The artist impressions and floorplans are indicative only, are not to scale and do not form part of any Contract of Sale. Any dimensions, finishes or specifications depicted are subject to change without notice. Consultants and agents do not warrant the accuracy of any information provided and do not accept any liability for negligence, any error, misrepresentation, discrepancy in the information or reliance thereon.

