



2/2A Aroo Road Ulladulla NSW

2 

Enjoying prominent road frontage to Blackburn Road as well as rear access and parking via Aroo Road, this well positioned industrial unit is currently tenanted. Located in the heart of the Ulladulla Industrial precinct, close to the Princess Highway and only 2 km south of Ulladulla CBD, this is the ideal factory unit to operate your own business. The complex is fully tenanted and the Industrial Area is occupied by a diverse range of businesses including Wombat Brewery, Haydens Pies, Studio 5 recording studio, Lagom Bakery and building and automotive enterprises. Currently tenanted by an automotive business on an periodic lease, the unit comprises an office, workshop, shower and toilet, high clearance roller doors front and back, front driveway and rear parking.

Call Craig 0434 311 113 to arrange your private inspection.

Building Size : 200 sqm
Land Size : 186 sqm
View : <https://www.coopercoastalproperties.com.au/sale/nsw/shoalhaven/ulladulla/commercial/industrial/7585300>



Craig Cooper
0434 311 113

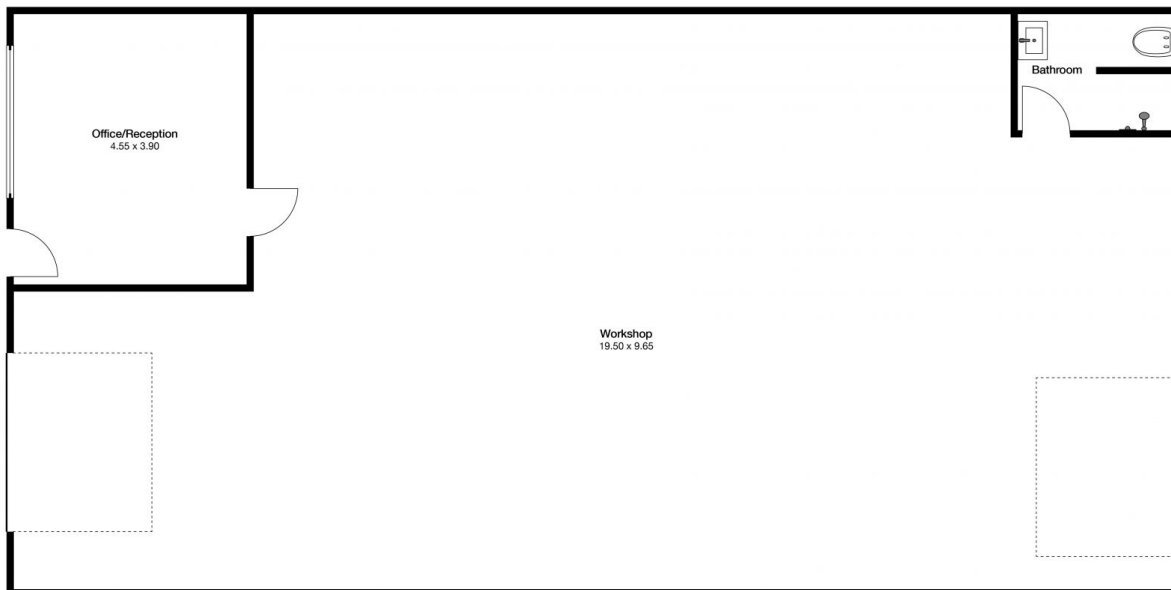

INTERIOR 186m²

2/2A Aroo Rd Ulladulla



Disclaimer: The artist impressions and floorplans are indicative only, are not to scale and do not form part of any Contract of Sale. Any dimensions, finishes or specifications depicted are subject to change without notice. Consultants and agents do not warrant the accuracy of any information provided and do not accept any liability for negligence, any error, misrepresentation, discrepancy in the information or reliance thereon.

