



## 24 Coral Tree Lane Little Forest NSW

4 2 4

Commanding vast district and ocean views, 'Skyview' is a truly unique rural property located beneath the Little Forest Escarpment in a tightly held area. Elevated and private, set over 25 acres of tranquil acreage, there are endless opportunities to make this your own.

Greet the day, with spectacular sunrises from the Master suite or stroll out onto the deck to breathe the fresh air, perhaps enjoying some early morning yoga. It's also the perfect place to relax with a drink or dine al fresco with the glorious backdrop adding wow factor.

Ideally positioned on the property is the large, single level home with stunning views from every room. The well designed floorplan offers privacy for parents with their own north east facing wing comprising a large master bedroom opening onto the deck, spacious ensuite, walk in wardrobe

**Building Size** : 553 sqm  
**Land Size** : 10.12 ha  
**View** : <https://www.coopercoastalproperties.com.au/sale/nsw/shoalhaven/little-forest/residential/acreagesemirural/7793785>



**Craig Cooper**  
0434 311 113

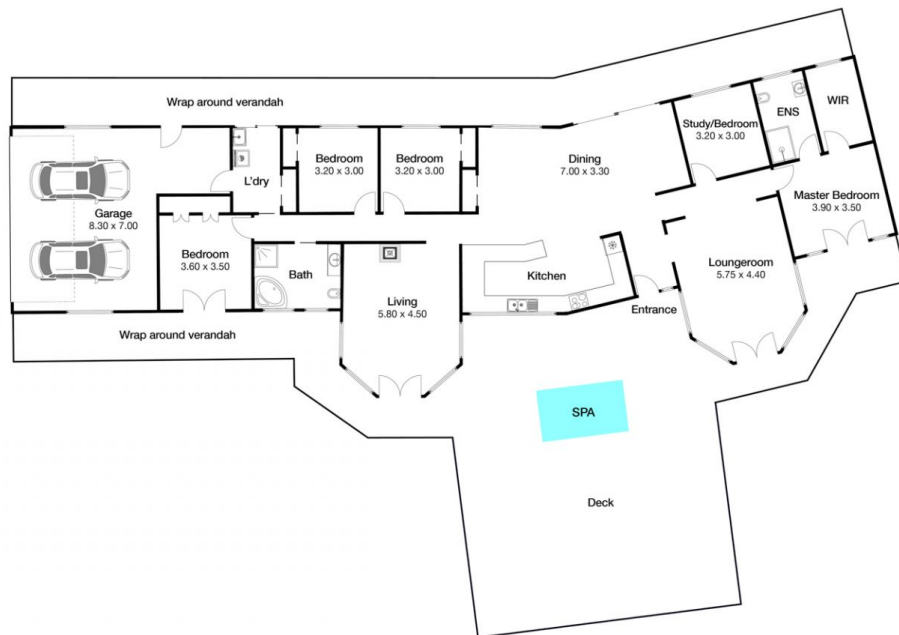
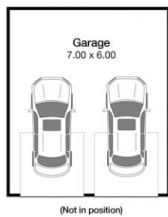

## 24 Coral Tree Lane Little Forest

INTERIOR 553m<sup>2</sup>

5 2 4



**Disclaimer:** The artist impressions and floorplans are indicative only, are not to scale and do not form part of any Contract of Sale. Any dimensions, finishes or specifications depicted are subject to change without notice. Consultants and agents do not warrant the accuracy of any information provided and do not accept any liability for negligence, any error, misrepresentation, discrepancy in the information or reliance thereon.

