



17 Gadu Street Dolphin Point NSW

6  3  2 

A stunning contemporary design set in a seaside location with views to Pigeon House Mountain and the Budawang Ranges. This recently completed home is ready for you to move in and start enjoying the laid back coastal lifestyle of Dolphin Point. Stroll to the nearby beach, lake or National Park. Walk or cycle to your local bakery & cafes to pick up coffee and breakfast, and then immerse yourself in all of the leisure activities on offer in Dolphin Point and Burrill Lake.

Delivering commanding street appeal with cladding, rendered brick, stone and timber finishes, this near new residence is light filled and spacious with high ceilings and highlight windows, offering laid back family friendly living - with space for everyone to spread out and relax.

A step inside reveals a carefully considered layout with

Price : Price By Negotiation
Building Size : 500 sqm
Land Size : 600.9 sqm
View : <https://www.coopercoastalproperties.com.au/sale/nsw/shoalhaven/dolphin-point/residential/house/7853510>



Craig Cooper
0434 311 113

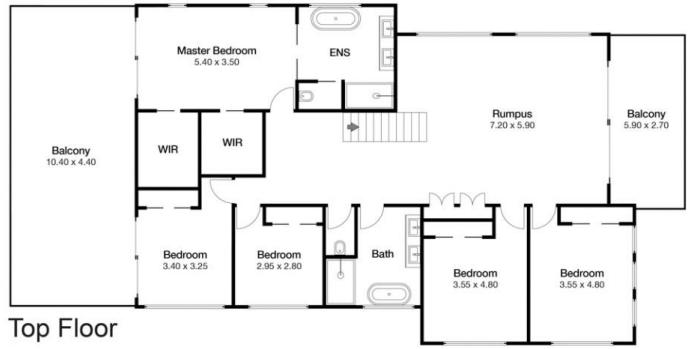

N

INTERIOR	500m ²
6	3
	2

17 Gadu St Dolphin Point



Disclaimer: The artist impressions and floorplans are indicative only, are not to scale and do not form part of any Contract of Sale. Any dimensions, finishes or specifications depicted are subject to change without notice. Consultants and agents do not warrant the accuracy of any information provided and do not accept any liability for negligence, any error, misrepresentation, discrepancy in the information or reliance thereon.

